



INSTRUCTIONS FOR
SPRING BALANCER (3.0 - 5.0KG)
 MODEL NO: **ATB3050**

Thank you for purchasing a Sealey product. Manufactured to a high standard, this product will, if used according to these instructions, and properly maintained, give you years of trouble free performance.

IMPORTANT: PLEASE READ THESE INSTRUCTIONS CAREFULLY. NOTE THE SAFE OPERATIONAL REQUIREMENTS, WARNINGS & CAUTIONS. USE THE PRODUCT CORRECTLY AND WITH CARE FOR THE PURPOSE FOR WHICH IT IS INTENDED. FAILURE TO DO SO MAY CAUSE DAMAGE AND/OR PERSONAL INJURY AND WILL INVALIDATE THE WARRANTY. KEEP THESE INSTRUCTIONS SAFE FOR FUTURE USE.



Refer to instruction manual



Wear protective gloves



Wear eye protection

1. SAFETY

- WARNING!** When no load is applied or a load is removed, continue to hold the cable and allow it to retract in a controlled fashion. Sudden release of the cable could cause injury.
- WARNING!** Ensure the hook used is capable of supporting the combined load of the balancer and any tools that may be attached.
- WARNING!** Ensure the tool is clipped securely to the cable and does not exceed the maximum load capacity of the balancer.
- WARNING!** Do not attempt to disassemble. Balancer contains a spring under tension which could cause serious injury. Any repairs must be carried out by an authorised service agent.

2. SPECIFICATION

Model no: ATB3050
 Weight Range: 3 - 5kg
 Cable Length: 1.35mtr

3. INTRODUCTION

Designed to support the weight of the tool, reduce operator fatigue and keep the benches and production lines free of clutter. Simple clip on tool attachment fitted to multi-strand steel cable. Fine load adjustment with hand wheel.

4. OPERATION

- 4.1. Hang the balancer from a suitably strong and secure hook capable of supporting tool and balance using the hole provided.
 - WARNING!** Ensure the tool is clipped securely to the cable and does not exceed the maximum load capacity of the balancer.
- 4.2. Turn the dial anti-clockwise to increase the spring tension i.e. for use with heavier tools.
 - WARNING!** Do not over tighten as this may well damage spring and mechanism.
- 4.3. To decrease the spring tension i.e. for use with lighter tools, activate the release lever and allow the dial to turn clockwise.
- 4.4. To alter the length of cable that remains outside the balancer housing when fully retracted, loosen the two screws holding the plastic stopper, reposition the stopper as desired, and re-tighten the screws.
- 4.5. Securely clip the end of the cable to the required tool.
 - WARNING!** When no load is applied or a load is removed, continue to hold the cable and allow it to retract in a controlled fashion. Sudden release of the cable could cause injury.

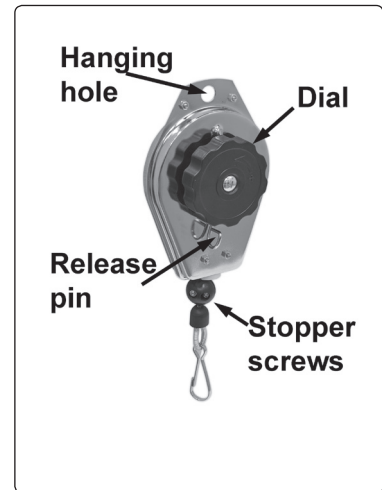

ENVIRONMENT PROTECTION
 Recycle unwanted materials instead of disposing of them as waste. All tools, accessories and packaging should be sorted, taken to a recycling centre and disposed of in a manner which is compatible with the environment. When the product becomes completely unserviceable and requires disposal, drain any fluids (if applicable) into approved containers and dispose of the product and fluids according to local regulations.

Note: It is our policy to continually improve products and as such we reserve the right to alter data, specifications and component parts without prior notice.
Important: No Liability is accepted for incorrect use of this product.
Warranty: Guarantee is 12 months from purchase date, proof of which is required for any claim.